

5/8" -11UPS-2B
 4 HOLES AT 90° ON 5.00" B.C.,
 5/8" DEEP BOTH ENDS

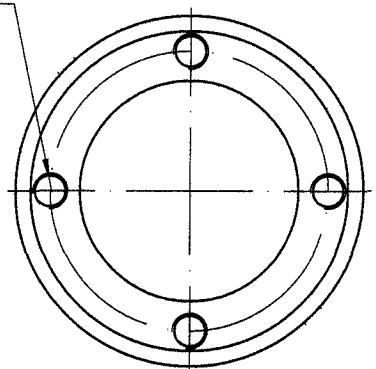

| | |
|--|-------|
| MECHANICAL CHARACTERISTICS | |
| CANTILEVER STRENGTH, LBS | 8000 |
| TENSILE STRENGTH, LBS | 28000 |
| TORSIONAL STRENGTH, IN-LBS | 40000 |
| COMPRESSION STRENGTH, LBS | 40000 |
| ELECTRICAL CHARACTERISTICS | |
| POS. CRITICAL F. O., kV | 105 |
| IMPULSE WITHSTND, kV | 95 |
| 60 HZ WET WITHSTAND, kV | 30 |
| RIV CHARACTERISTICS | |
| 60 HZ TEST VOLTAGE, kV | 5 |
| MAX. RIV AT 1000 KHz, vV | 50 |
| PHYSICAL CHARACTERISTICS | |
| LEAKAGE DISTANCE, IN | 10.5 |
| COLOR: GRAY | |
| TESTED PER ANSI C29.1 (LATEST REVISION) & ANSI C 29.9 (LATEST REVISION) | |

| | | | | | | | | | |
|---------|-----|------------|------|------|---|-----------|----------------|--------|--------|
| | | | | | 95kV -BIL NON-STACKING STATION POST | | DRAWING # | 041010 | |
| | | | | | | | PHASE SIGN | WEIGHT | SCALE |
| | | | | | | | | | |
| SIGN | QTY | REJIGGER # | NAME | DATE | INSULATOR | | TOTAL 1 PAGES | | PAGE 1 |
| DRAWN | | | | | | | NEWELL-PSN LLC | | |
| CHECKED | | | | | | | | | |
| APPROVE | | | | | | | | | |
| DATE | | | | | MATERIAL | PORCELAIN | | | |