

Top & bottom installation holes

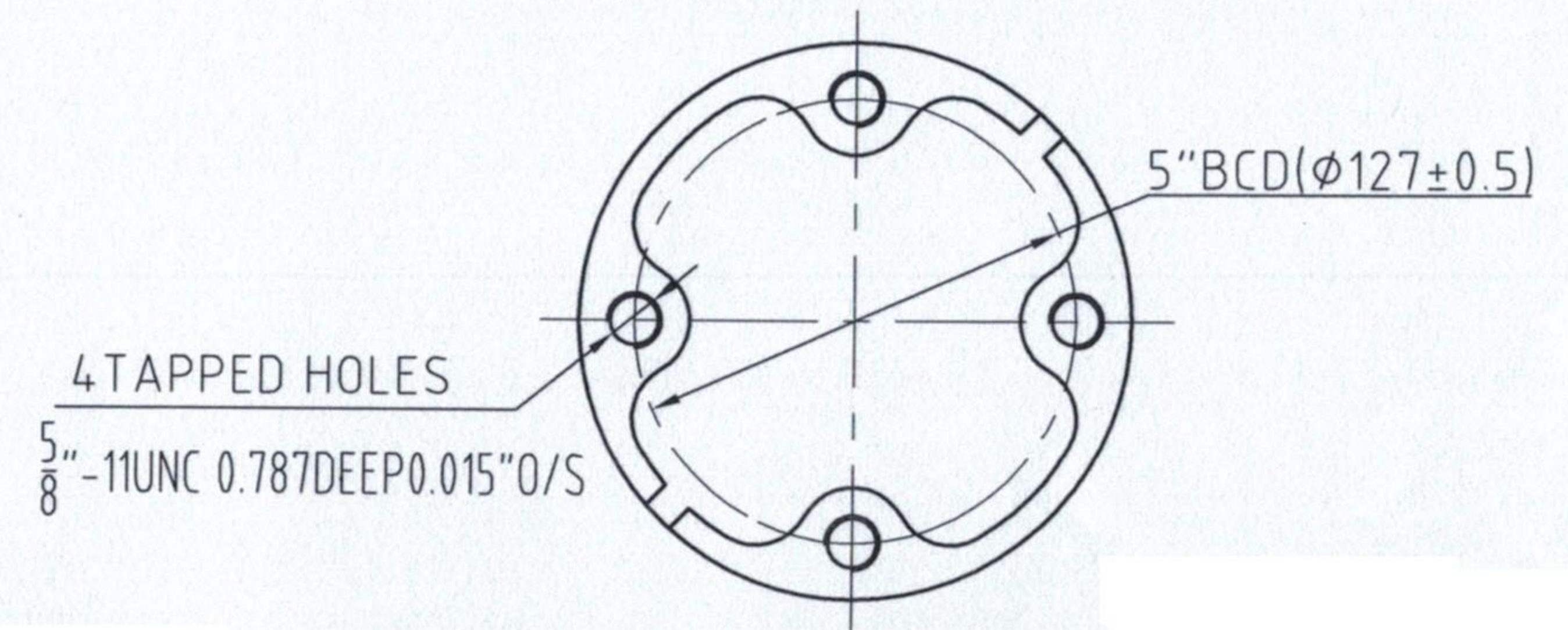

Technical requirements:

- 1. Lightning impulse withstand voltage; 200kV
- 2. Wet power frequency withstand voltage; 80kV
- 3. Critical impulse flashover voltage (Positive); 225kV
- 4. RIV DATA :
  - Low frequency test voltage; 22kV
  - Max RIV @ 1000 kHz ; 100 μ V
- 5. Min. creepage distance; 37IN(940mm)
- 6. Ultimate bending strength; 8000lbs(35.6kN)
- 7. Ultimate tensile strength; 28000lbs(124.5kN)
- 8. Ultimate compression strength; 40000lbs(177.8kN)
- 9. Ultimate torsional strength; 40000In-lbs(4.52kN·m)
- 10. Color; Grey
- 11. Applicable standard; ANSI C29.9

				Assembly drawing			041020-7001	
							Anti Pollution-type outdoor solid-core post insulator	
				PHASE SIGN			weight	scale
							35kg	
DRAWN	刘淑兰			DATE		2015.9.24		Sinoma Advanced Materials Co. Ltd
CHECKED	刘淑兰							
APPROVE	刘淑兰							